

Some more tips and tricks to help you optimise your workflow with Cetopo and Revit

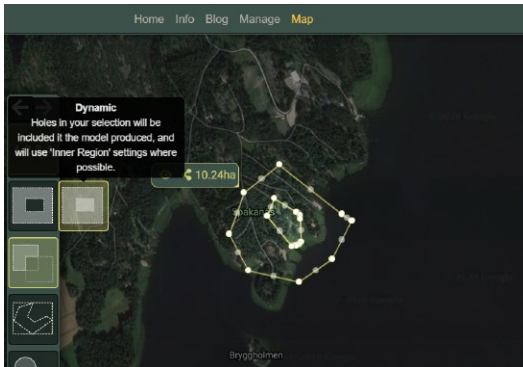

TIP ONE: MULTIACCURACY

For larger area models, multiaccuracy models can keep the model light and quick to use. Using the dynamic holes selection tool, download using the appropriate Revit template.

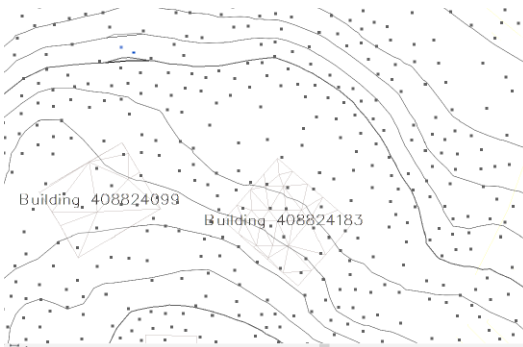

TIP TWO: TEMPLATE EDITS

Templates can be customised to suit your needs, and allow you lots of control over the detail, and which information is included. Using the 'share' button, you can download a template file to share with your colleagues.

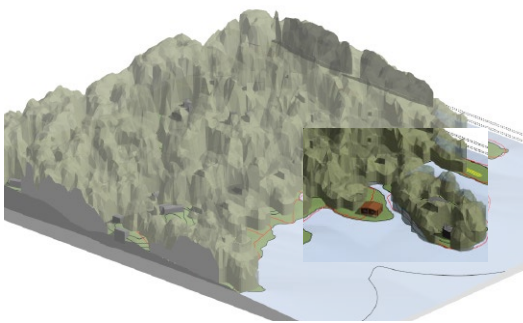

TIP THREE: CONTOUR EDITS

Use 'edit surface' to move individual points along contours. Revit will automatically adjust the other points to create a smooth model.

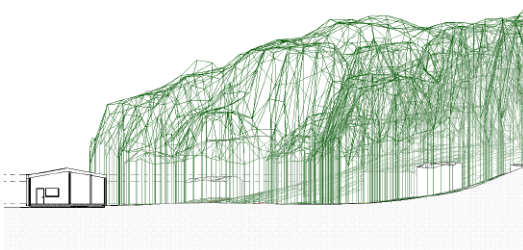

TIP FOUR: LINKING MODELS

When linking models, you can either set the coordinates so that the model sits in place automatically, or you can move it manually to its position.

TIP FIVE: DRAWING SECTIONS

The best way to create sections with Cetopo models is to use a 3D view, with a section box, as Revit sections will not cut through the forest mesh. You can then apply your usual section view template to this.

